



User Manual

Product Introduction

Please read this manual carefully before using the product.

Rotary button

Rotate: switch dials/scroll app list and interface
Click: open app list/return to the previous level
Double-click: toggle menu style
Long press: open the volume bar

Power button

Long press: power on/off/restart
Single Click: wake up / Screen off / Return to main dial screen
Double click: open multi-task interface
Screenshot: press the rotary button and power button at the same time
Forced reboot: long press the power button for over 10 seconds.

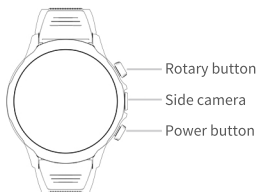

⚠ In the case of crash or stuck machine, long press the power button for more than 10 seconds, the machine will be forced to restart.

Power on&Charge

Press and hold the power button to power on.
Align the charging area of the watch with the front of the charging base, and the charging base will automatically attach to it until the charging interface appears on the watch's screen.

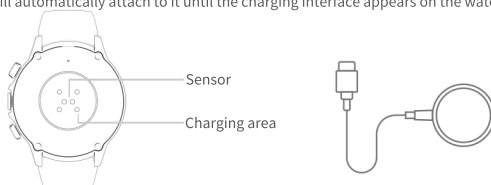

⚠ If the battery power is too low, the watch will not turn on. Please charge it in time.

Install the SIM Card

Please use a standard Nano-SIM card and ensure the metal chip of the SIM card No soiled or oxidized surface.
Please refer to the directions shown to place the SIM card

Align the notch with the notch of the card slot and the SIM card into the slot, put once in place, align the card slot with the opening on the watch, and then place. Push the card slot into the watch.

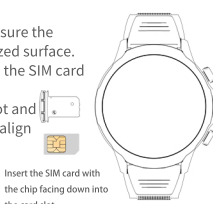

⚠ After inserting the SIM card, need to hold down the power button to restart the watch to read the SIM card.

Instructions

- Slide down from the top of the watch face home page: Open the Notifications and Status bar
- Slide from right to left on the main page of the watch face: Switch the function card
- Slide from left to right on the main page of the watch face to open the Call menu
- Slide from left to right on other pages: return to previous level

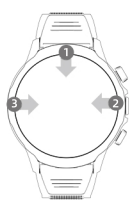

App install and uninstall

App Installation

- Find the Google play store from the watch function menu, download and install the app directly
- Find Google Play Store in the function menu, download and install directly from Google Play Store

App Uninstall

- Find the Google Play Store in the function menu, click to open it and find the three horizontal bars on the upper left corner, then find the application management on the lower left corner, open it and find the corresponding "Software Management" to uninstall.
- Find Settings in the function menu, find "Apps and Notifications" in Settings, view all apps, and find the corresponding software to uninstall.



Status Bar

- Bluetooth: Displays the Bluetooth switch status.
- WiFi: Display WIFI switch status, long press to jump to setting.
- Flight Mode: Click to activate Flight Mode.
- Traffic Internet access: Traffic switch
- Brightness: Slide to adjust the screen brightness.
- Silent mode: After opening, the watch is silent (there is sound on and off the machine).
- Location information: Accurate positioning after opening.
- Volume: Adjustable volume.
- High Audio Drainage: uses volume frequency vibration to achieve drainage.
- Zoom: Zoom in and zoom out.
- Ratio: round screen square screen switching



⚠ The actual display is subject to the watch status bar

Safety and precautions

- Please wear the watch about one finger from the wrist bone. Wearing the watch too loosely may affect the heart rate and blood oxygen data. When selecting heart rate and blood oxygen measurement on the watch, please keep your wrist still during the measurement.
- The watch has been tested and shown to be waterproof and dust-proof in a specific environment. It can be used while exercising (with access to sweat), in the rain or when washing hands.
- The watch is not resistant to seawater, acid and alkaline solvents, chemical reagents and other corrosive liquids.
- Please use this device within the temperature range of 0°C to 45°C. When the ambient temperature is too high or too low, it may cause device malfunctions.
- Please use the charging cable attached to this device for charging. When charging with a power adapter, a power adapter with a rated output voltage of 5V and a rated output current of 1A that meets the requirements of the corresponding safety standards should be used. When the device is charging, please keep the power adapter, the charging cable and the device in a dry environment. Do not touch the power adapter and the charging cable with wet hands, and ensure that the power adapter, the charging cable and the device are not rained on or soaked by liquids.
- The product contains a non-removable lithium battery, please do not replace the battery yourself to avoid damage to the battery or the device. Improper disposal of the battery may result in an explosion.
- Do not disassemble, impact, squeeze or put the device into the fire to avoid explosion. If the battery is severely swollen, do not continue to use it.
- Do not expose the device to high temperatures or around heating devices for a long time, such as sunlight, heaters, microwave ovens, ovens, or water heaters. Overheated batteries may cause explosions.
- The device and accessories may contain some small parts. Please keep them out of the reach of children.
- This device is not a medical device, and any data/information provided by the product should not be used as the basis for diagnosis, treatment and prevention of diseases.

Product Information

Basic parameter
Product Name: Android Smart watch
Card mode: nano sim card
Operating temperature :0°C to 45°C
Waterproof: IP67
Input rating:5V-1A

Packing List
Smart watch x1
User manual x1
Watch strap x1
Charging cable x1